

Optical USB Mouse

Operating Instructions
Mode d'emploi
Manual de instrucciones

SMU-C3

© 2007 Sony Corporation Printed in China

English

WARNING

To reduce the risk of fire or electric shock, do not expose this apparatus to rain or moisture.

Notice for the customer in the countries applying EU Directives

The manufacturer of this product is Sony Corporation, 1-7-1 Konan, Minato-ku, Tokyo, Japan. The Authorized Representative for EMC and product safety is Sony Deutschland GmbH, Hedelfinger Strasse 61, 70327 Stuttgart, Germany. For any service or guarantee matters please refer to the addresses given in separate service or guarantee documents.



Disposal of Old Electrical & Electronic Equipment (Applicable in the European Union and other European countries with separate collection systems)

This symbol on the product or on its packaging indicates that this product shall not be treated as household waste. Instead it shall be handed over to the applicable collection point for the recycling of electrical and electronic equipment. By ensuring this product is disposed of correctly, you will help prevent potential negative consequences for the environment and human health, which could otherwise be caused by inappropriate waste handling of this product. The recycling of materials will help to conserve natural resources. For more detailed information about recycling of this product, please contact your local Civic Office, your household waste disposal service or the shop where you purchased the product.

Customer Support

The following URL contains information on the latest customer support for the mouse, and frequently asked questions and answers. http://www.sonybiz.net/pcperipherals

On copyright

- Microsoft, Windows, and Windows Vista are registered trademarks of Microsoft Corporation in the United States and/or other countries.
- Mac OS is a trademark of Apple Computer, Inc., registered in the U.S. and other countries.
- All other names of company and products are trademarks or registered trademarks of their respective owners. ™ and © marks are omitted in this manual.
- Copyright laws prohibit reproducing the software supplied with this mouse or the manual accompanying it in whole or in part, or renting the software without the permission of the copyright holder.
- In no event will SONY be liable for any financial damages, or loss of profits, including claims made by third parties, arising out of the use of the software supplied with this mouse.
- In the event a problem occurs with this product as a result of defective manufacturing, SONY will replace it. However, SONY bears no other responsibility.
- The software provided with this mouse cannot be used with equipment other than that which is so designated.
- Please note that, due to continued efforts to improve quality, the specifications of the software supplied with this mouse may be changed without notice.

Unpacking Your Mouse

Check that the package contains before using this product. If anything is missing, contact the Sony dealer where you purchased this product or a Sony service representative serving your local area.

- Mouse SMU-C3

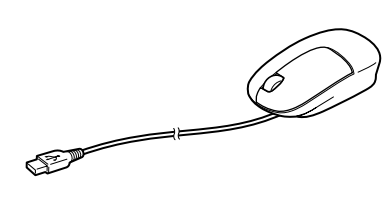

- Operating instructions (4)
- Warranty card (1)

Identifying the Parts

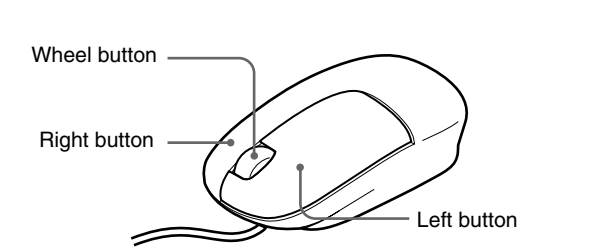

Specifications

Connector
USB connector
Resolving power
800 counts/inch
Supported OS
Windows Vista® Home Basic, Windows Vista® Home Premium, Windows Vista® Business, Windows Vista® Ultimate, Windows® XP Media Center Edition 2005, Windows® X Media Center Edition 2004, Windows® XP Professional, Windows® XP Home Edition, Windows® 2000 SP3
Mac OS X Version 10.2, 10.3, 10.4, 10.5
(Manufacturer installed)
Cord length
Approx. 1.8 m
Operating temperature
5°C to 35°C
Operating humidity
20% to 80% (not condensed)
Storage temperature
−10°C to 60°C
Storage humidity
10% to 90 % (not condensed)
Dimensions
Approx. 64.3 × 32 × 99.7 mm (w/h/d)
Mass
Approx. 70 g (including the cord)

Design and specifications are subject to change without notice.

Connecting the Mouse

You can use this mouse by connecting it to a USB port of your computer.

Connect this mouse to a USB port of your computer. The mouse is recognized by your computer, and is ready for use.

Notes

- When you connect this mouse to your computer, or when you start up your computer, do not move this mouse until it is identified.
- Do not connect to a computer using a USB hub.

- Start up your computer.**
- Connect this mouse to a USB port of your computer.**

Your computer automatically recognizes the mouse, allowing you to use it.

Notes

- Some computers may require installing an OS disk. In this case, follow the directions shown on your computer.
- Depending on the condition of the computer or OS, operation of this mouse may become unstable or impossible. In such a case, refer to “Troubleshooting.”
- After disconnecting this mouse from the USB port, wait about five seconds before reconnecting it. (If you reconnect it immediately, it may not be recognized.)

Tip

You can connect/disconnect this mouse without turning off the power of your computer.

Adjusting the cord

- Turn the mouse over.**
- Open the cover as shown, then adjust the cord length.**

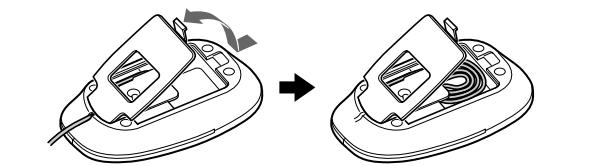

- Close the cover of the mouse.**

Tip

You can retrieve the cord and plug into the empty space.

Notes

- If you place the entire cord inside the mouse, be careful not to pinch it, when you close the cover.
- Do not pull the cord strongly. It may cause damage.
- Do not wind the cord around the body of the mouse, as it may leave impressions on the soft body or damage the buttons.

Troubleshooting

If you experience any of the following difficulties while using this mouse, refer to this troubleshooting guide to help remedy the problem. If the problem persists, consult your nearest Sony dealer.

My mouse does not work.

- The mouse is not recognized by your computer through the USB port to which the mouse is connected.**
 - If your computer has more than one USB port, try connecting the mouse to another USB port. (After disconnecting the mouse from the USB port, reconnect it after about five seconds.)
 - Turn off the power of your computer while the mouse is connected to it, then start it up again after about 30 seconds. (If your mouse still does not work, repeat this procedure several times.)
- The optical sensor is not working properly.**
 - Due to the nature of this optical mouse, do not use the mouse on glass, a mirror, or glossy surfaces as it will not work properly. Use the mouse with a mouse pad, or lay something suitable under it.
- The USB connector is not connected properly.**
 - After closing all the applications, reconnect the USB connector. (After disconnecting the mouse from the USB port, reconnect it after about five seconds.)
- The mouse is connected through a USB hub or a keyboard.**
 - Connect the mouse directly to your computer.
- The USB port is disabled by your computer. [For Windows]**
 - Try the following, using the keyboard or another functional mouse. Double-click the [System] icon in the [Control Panel], and click [Device Manager]. If [!] is displayed for the USB device icon or the mouse icon, choose [!] and click [Delete], then restart your computer.
- The USB port is disabled in the BIOS settings. [For Windows]**

AVERTISSEMENT

Afin d’éviter tout risque d’incendie ou d’électrocution, n’exposez pas cet appareil à la pluie ou à l’humidité.

Avis à l’attention des clients des pays appliquant les directives UE

Le fabricant de ce produit est Sony Corporation, 1-7-1 Konan, Minato-ku, Tokyo, Japon. Son représentant autorisé concernant la CEM et la sécurité du produit est Sony Deutschland GmbH, Hedelfinger Strasse 61, 70327 Stuttgart, Allemagne. Veuillez vous référer aux adresses indiquées dans les documents d’entretien ou de garantie séparés concernant toute question relative à l’entretien et à la garantie.

The pointer sometimes does not move even though the mouse works.

- The mouse is in the auto scroll mode.**
 - Press the wheel button to exit this mode.
- The optical sensor is not working properly.**
 - Due to the nature of this optical mouse, do not use the mouse on glass, a mirror, or glossy surfaces as it will not work properly. Use the mouse with a mouse pad, or lay something suitable under it.

Nothing happens when I press the buttons of the mouse.

- The USB connector is not connected properly.**
 - After closing all the applications, reconnect the USB connector.
- This mouse does not support the OS of your computer.**
 - Use an OS that this mouse supports.

The scrolling features do not work.

- This mouse does not support the OS of your computer.**
 - Use an OS that this mouse supports.
- An application that does not support the scrolling features is open.**
 - Some applications do not support the scrolling features.

Pointer speed cannot be set on a notebook computer.

Priority is given to the pointing device built into the notebook computer. Therefore, it may not be possible to set up with a USB-connected mouse.

The mouse property settings are disabled. [For Windows]

- More than one mouse is connected to USB ports.**
 - Disconnect every mouse except this one.
- Utility driver software for another mouse is installed.**
 - Uninstall the utility driver software and then restart your computer. The operating system’s mouse property settings become effective. For details about uninstalling, refer to the manual, etc., of your utility driver software. (A touchpad function may be disabled when you use a notebook computer.)

Even if the wheel button is rotated, the zoom function does not operate.

- The application does not support the zoom function.**
 - The zoom function cannot be used with applications that do not support the zoom function.

Even while my mouse is in use, the display is dark, or the computer enters the System Standby mode or the System Hibernation mode.

- Depending on the USB equipment you use, the computer may enter the System Standby mode or the System Hibernation mode even while the USB equipment is being used.**
 - To prevent your notebook computer from entering these modes, change the power management settings of the computer. For details, refer to the manual or online manual of your notebook computer.
 - Touch the touchpad or press any key to exit these modes.

Precautions

CAUTION

Your health may be affected if you do not follow the caution below. Prolonged use of this product may strain your wrist or arm. If you feel any pain during use, stop immediately and take a rest. If the pain persists, even after a prolonged rest, consult a doctor.

On safety

Should any solid object or liquid fall into the casing, disconnect the USB mouse and have it checked by qualified personnel before continuing use.

On placement

Do not place the USB mouse in a location where it is:

- On an unstable surface
- On a rug or carpet
- In very humid areas, or where there is no ventilation
- Subject to excessive dust
- Subject to direct sunlight or extreme heat
- Extremely cold
- In a car with the windows closed.

On operation

If the USB mouse is brought directly from a cold to a warm location, or is placed in a very damp room, moisture may condense on the inside of the mouse. If this occurs, the mouse may not work properly. In this case, wait about 30 minutes for the moisture to evaporate. If the mouse does not work properly after one hour, consult your nearest Sony dealer.

Sony is exempt from responsibility for any malfunction or other problem caused as a result of using this mouse.

Français

Déballage de votre souris

Vérifiez que l’emballage contient bien tous les accessoires avant d’utiliser ce produit. S’il manque un accessoire, contactez le revendeur Sony où vous avez acheté ce produit ou le représentant du service après-vente Sony de votre région.

- Souris SMU-C3

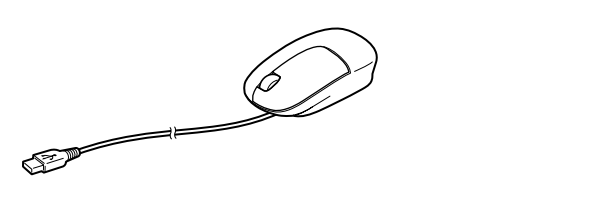

- Mode d’emploi (4)
- Carte de garantie (1)

Identification des pièces

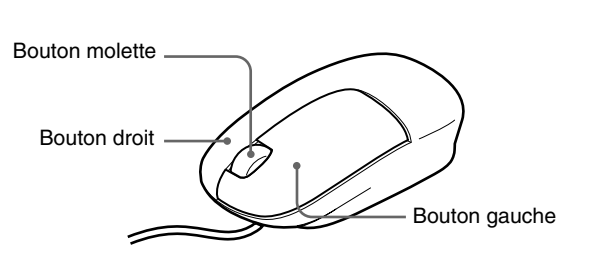

Spécifications

Connecteur
Connecteur USB
Pouvoir de résolution
800 points/pouce
Systèmes d’exploitation pris en charge
Windows Vista® Home Basic, Windows Vista® Home Premium, Windows Vista® Business, Windows Vista® Ultimate, Windows® XP Media Center Edition 2005, Windows® XP Media Center Edition 2004, Windows® XP Professionnel, Windows® XP Edition Familiale, Windows® 2000 SP3
Mac OS X Version 10.2, 10.3, 10.4, 10.5
(installés par le fabricant)
Longueur du cordon
Environ 1,8 m
Température de fonctionnement
5 °C à 35 °C
Humidité de fonctionnement
20 % à 80 % (sans condensation)
Température de stockage
− 10 °C à 60 °C
Humidité de stockage
10 % à 90 % (sans condensation)
Dimensions
Environ 64,3 × 32 × 99,7 mm (l/h/p)
Poids
Environ 70 g (avec le cordon)

La conception et les spécifications sont susceptibles d’être modifiées sans préavis.

Raccordement de la souris

Vous pouvez utiliser cette souris en la raccordant à un port USB de votre ordinateur.

Raccordez cette souris à un port USB de votre ordinateur. La souris est alors identifiée par votre ordinateur et est prête à être utilisée.

Remarques

- Lorsque vous raccordez cette souris à votre ordinateur ou lorsque vous démarrez votre ordinateur, ne déplacez pas cette souris avant qu’elle ne soit identifiée.
- Ne raccordez pas la souris à un ordinateur à l’aide d’un concentrateur USB.

- Démarrez l’ordinateur.**
- Raccordez cette souris à un port USB de votre ordinateur.**

Votre ordinateur identifie automatiquement la souris. Vous pouvez alors l’utiliser.

Remarques

- Certains ordinateurs peuvent nécessiter l’installation d’un disque de système d’exploitation. Dans ce cas, suivez les instructions affichées sur l’écran de votre ordinateur.
- Selon l’état de l’ordinateur ou du système d’exploitation, il est possible que l’utilisation de la souris soit instable voire impossible. En pareil cas, reportez-vous à la section « Dépannage ».
- Une fois la souris débranchée du port USB, attendez environ cinq secondes avant de la rebrancher. (Si vous la rebranchez immédiatement, elle risque de ne pas être identifiée.)

Conseil

Vous pouvez brancher/débrancher cette souris sans mettre votre ordinateur hors tension.

